



# 100 Series Gas Check Valves

## Features & Benefits

Specialist CNG check valve designed for long life applications.

Simple robust design.

Proven in over 25 countries

Specified internationally for over 20 years

Single piece, certified bar stock.

Tamper proof.



## Materials

ITEM	DESCRIPTION	CV102 MATERIAL	CV103 MATERIAL
1	Body	T303 Stainless steel*	T303 Stainless steel*
2	Poppet	385 brass	Acetal
3	Spring Retainer	385 brass	385 brass
4	O-ring retainer	385 brass	-
5	Poppet spring	T304 Stainless steel*	T304 Stainless steel*
6	Poppet O-ring	Nitrile	Nitrile

\* 316 Stainless steel available on request.

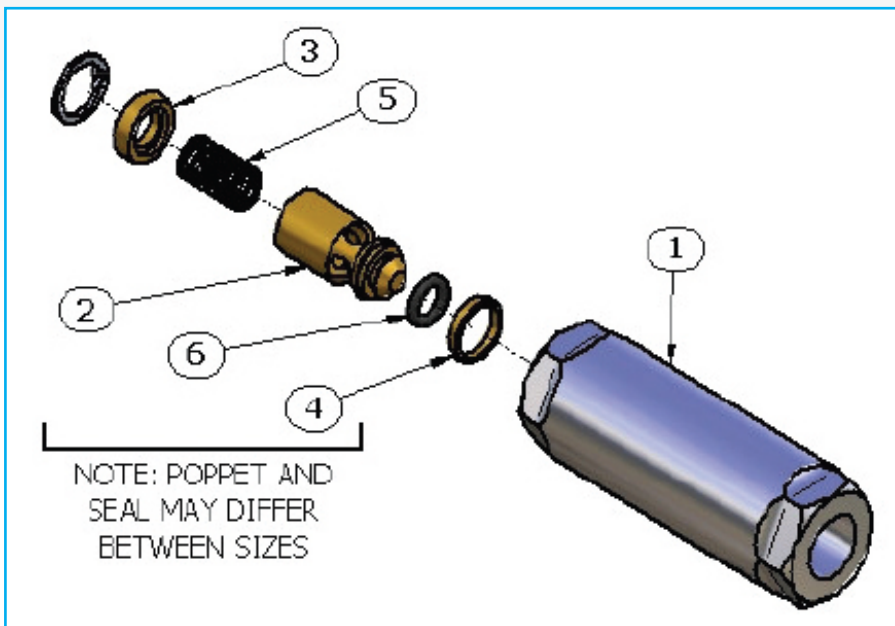



## 100 Series Gas Check Valves

### Applications

- CNG dispenser.
- Storage Vessels.
- Priority panels.
- Compressors.

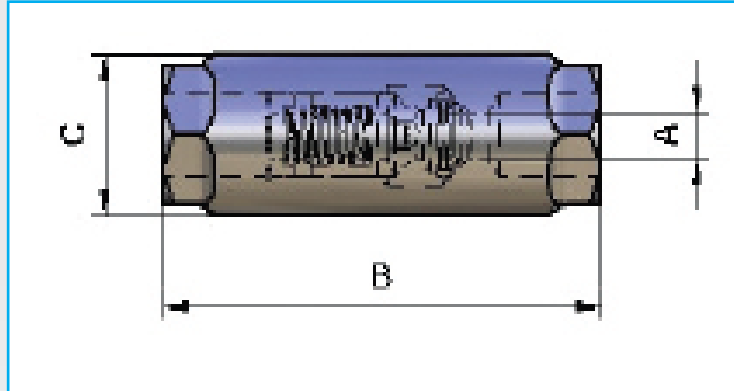

### Dimensions (mm)

PART CODE	Bore A	Length B	Diameter C
CV102	6.4	64	22
CV103	9.6	76	28

Operating Pressure Range up to 6000 PSI.

Burst Pressure > 20,000 PSI.

NPT is standard quoted thread. SAE, BSP available or as per customer request.

All products are manufactured to ISO 9001:2000 standards.