



OSE Series Electrical Isolating Couplers

Features & Benefits

High pressure flow of gases creates static electricity. The OSE series Electrical Isolating Couplers dissipates this charge, whilst maximising flow rate.

Forms part of the cathode/anode corrosion resistance for underground installations.

Minimal back pressure on gas pipe systems.

Fully serviceable.

Threading options are totally user defined.

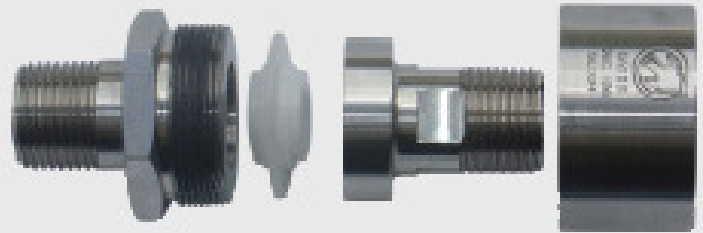

Materials

ITEM	PART	MATERIAL
1	Male Body	T304 Stainless steel*
2	Female Body	T304 Stainless steel*
3	Body Nut	T304 Stainless steel*
4	Isolating Flange	Acetal
5	Isolating Washer	Acetal
6	O Rings	Nitrile N90**

* T316 Stainless steel available on request.

** Viton available on request.

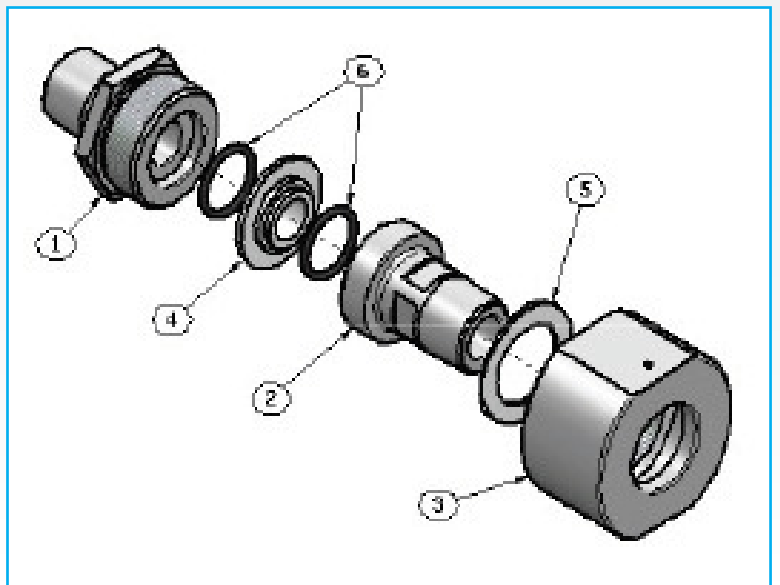



OSE Series Electrical Isolating Couplers

Applications

Between all CNG compressor stations, storage vessels, transport units and dispensers.

Complies with all International CNG industry best practice codes.

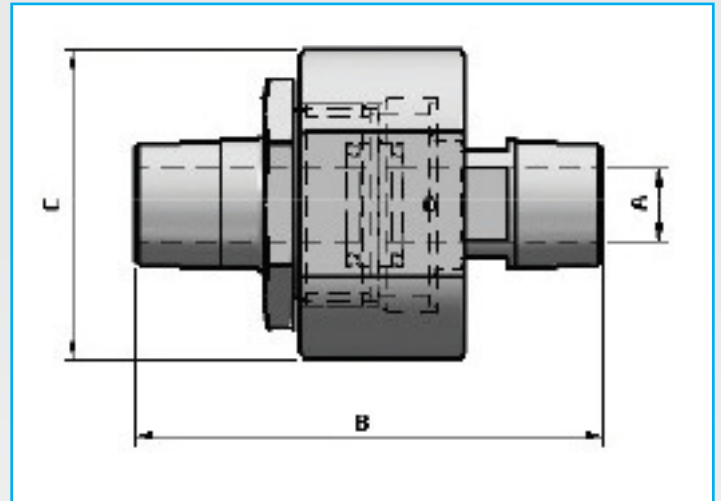

Dimensions (mm)

PART CODE	Bore A	Length B	Diameter C	C _v *	K _v ⁺
EC104	10	88	45	12	11
EC106	15	103	64	24	21
EC108	22	130	74	50	43

* C_v = USGPM - PSI.

+ K_v = M³/hr - Bar.

Rated 3600 PSI, burst pressure >16,000 PSI.

All Oasis OSE series have been tested for burst & proof.

NPT female is standard quoted thread. SAE, BSP & "weld in" ends available or as per customer request.

All products are manufactured to ISO 9001:2000 standards.

Full flow options can be customised to meet your needs, talk to Oasis, Engineer to Engineer.