



# HC400 Series

## High Pressure Quick Release Coupler

### Instruction Manual

#### **⚠ WARNING**

Failure to follow these instructions or to properly install and maintain this equipment could result in gas leakage, fire or explosion causing property damage and personal injury or death.

Oasis products must be installed, operated and maintained by trained and competent personnel in accordance with all applicable local codes, rules and regulations in addition to the Oasis Instructions.

Oasis Engineering Ltd. will not be held liable in such circumstances where installation, operation and maintenance procedures were performed by incompetent personnel resulting in improper assembly, unsafe operation, equipment damage or personal injury.

Oasis Engineering Ltd  
129 Birch Avenue, Tauranga, New Zealand.  
T: +64 7 928 3808  
E: [info@oasisNGV.com](mailto:info@oasisNGV.com)  
W: [www.OasisNGV.com](http://www.OasisNGV.com)



## Warning!

**High pressure gas and gas equipment can cause serious harm to both infrastructure and personnel if safety precautions are not followed.**

**Oasis recommends considering the use of the following PPE when working with high pressure along with any other site specific health and safety requirements:**



**Foot Protection**



**Hearing Protection**



**Safety Helmets**



**Hand Protection**



**Safety Glasses**



**Ensure the system is clean of debris, vented and isolated before any installation or servicing work is carried out.**

## To help with coupling in cold conditions



**Interflon Fin Super (Aerosol) or a similar product**

If coupler is hard to uncouple due to cold temperature icing, spray both male & female coupling faces with Interflon Fin Super (aerosol) or a similar product to help with ease of uncoupling in cold conditions.

## Tools Required



**Anaerobic Thread Sealant with PTFE (Optional)**

- Loctite 567
- Swagelok SWAK
- Hernon Driptest 940
- Gasoila FasSeal-ATS
- Or Similar



**Spanner (Wrenches)**



**Anti Seize Grease**

- Swagelok Silver Goop
- Omega 99
- or similar



**Yellow, Gas Rated, PTFE Thread Tape**

- AW TITASEAL
- McMaster-Carr High-Density Thread Sealant Tape
- Blue-Monster gas-guard
- Or Similar



**Spray bottle (Snoop or suitable equivalent)**



**Silicone Grease**

## 1. Apply thread tape and thread sealant.

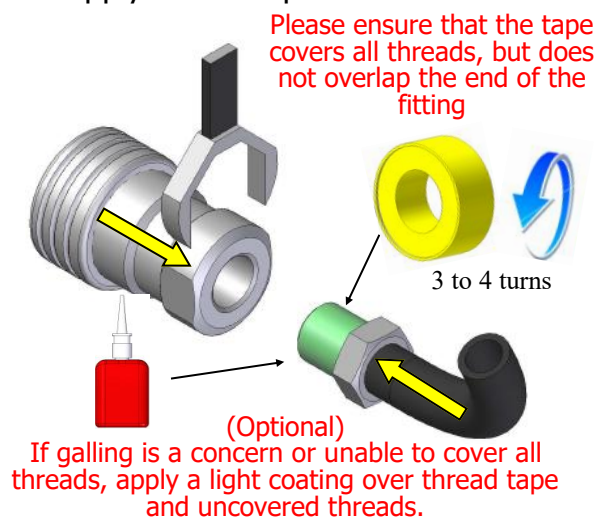

## 3. Female install complete, check for leaks on first use with snoop or soapy water.

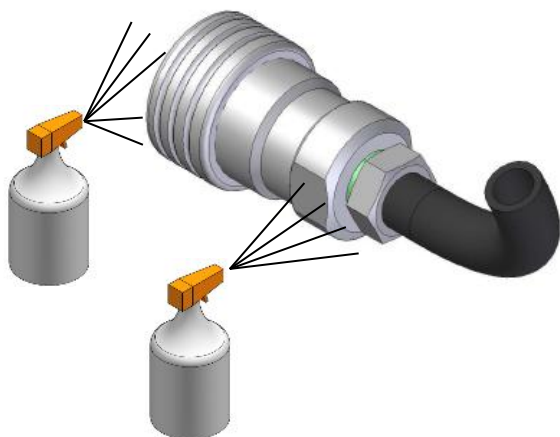

## 5. Join and tighten connection.

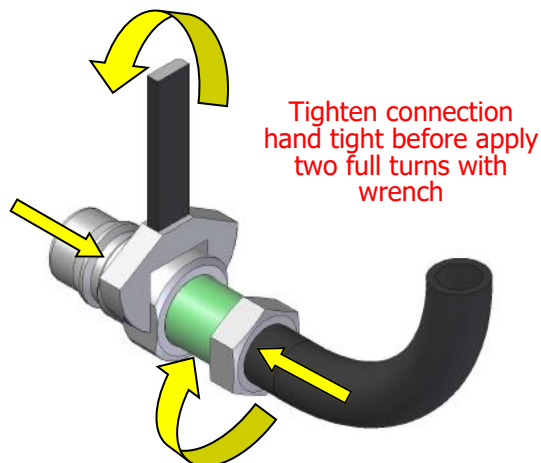

## 2. Join and tighten the connection.

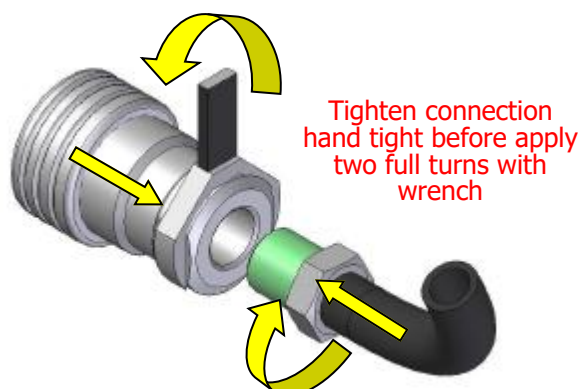

## 4. Apply thread tape and thread sealant.

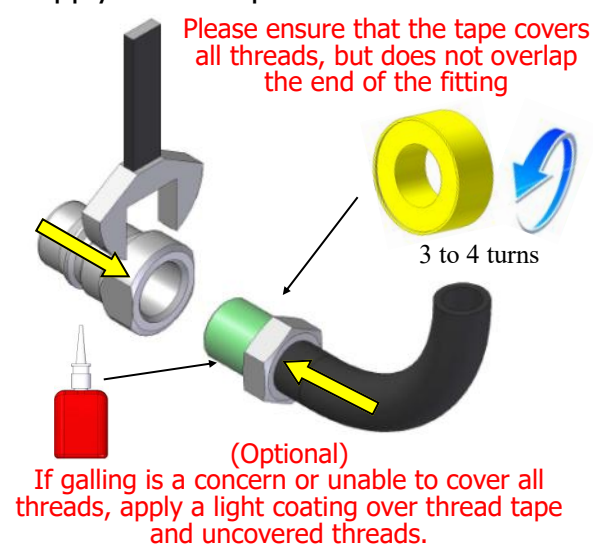

## 6. Male install complete, check for leaks on first use with snoop or soapy water.

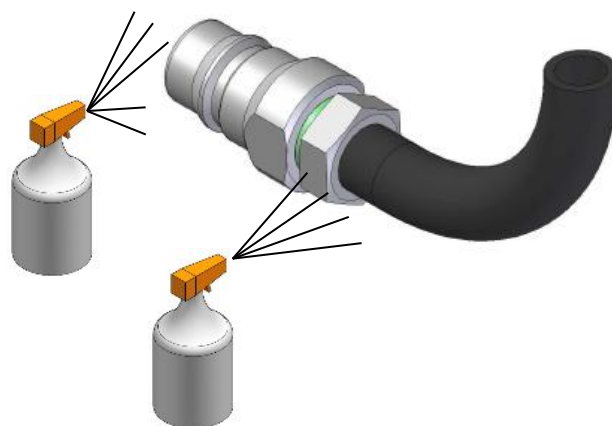



1. Apply anti seize to thread and Silicone grease to the O-ring. Install the O-ring on the fitting if not pre-installed.

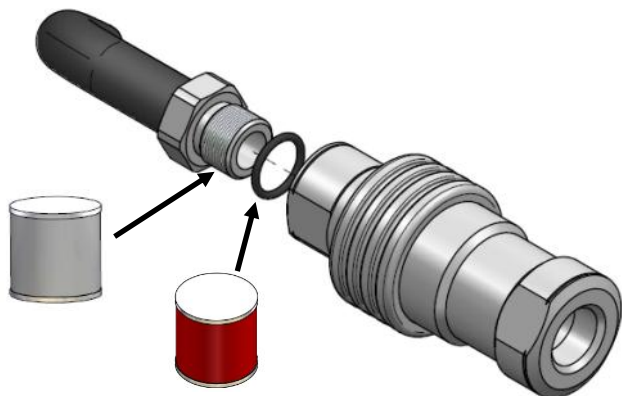

2. Screw the fitting into the body and torque to the fitting suppliers recommended tightening torque.

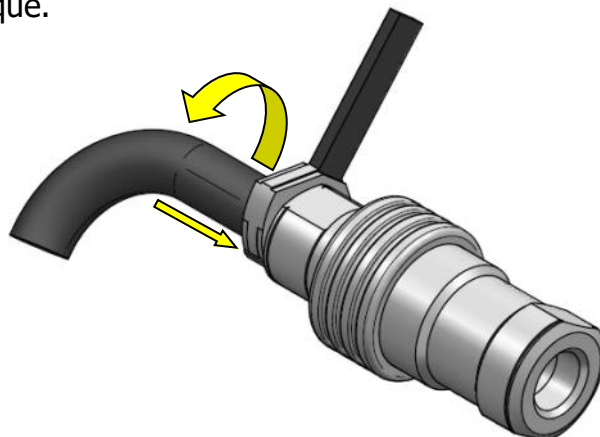

3. Apply anti seize to thread and Silicone grease to the O-ring. Install the O-ring on the fitting if not pre-installed.

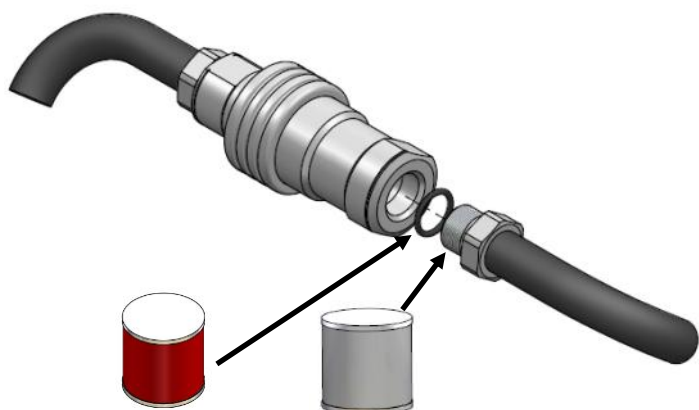

4. Screw the fitting into the body and torque to the fitting suppliers recommended tightening torque.

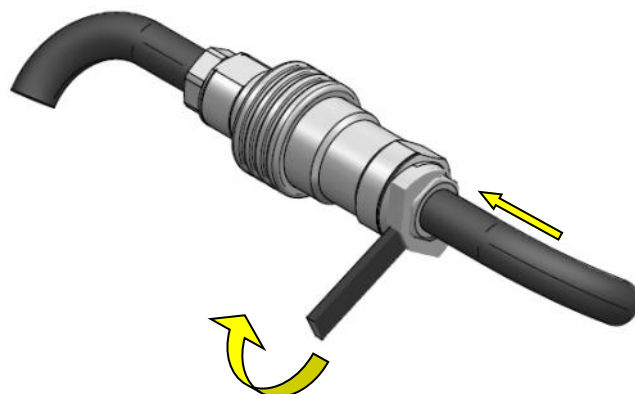

5. Correctly tightened SAE port fittings should bottom out on the port face and the O-ring should neatly fill the void creating the seal.

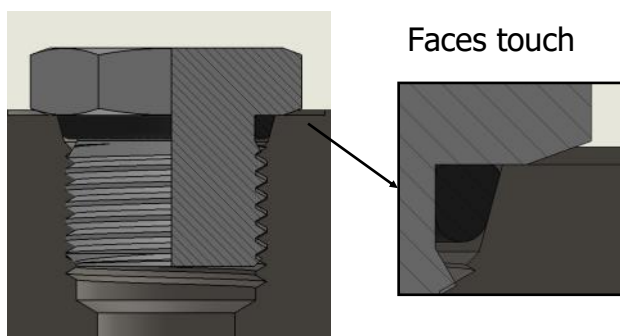

6. Installation complete, check for leaks on first use with snoop or soapy water.

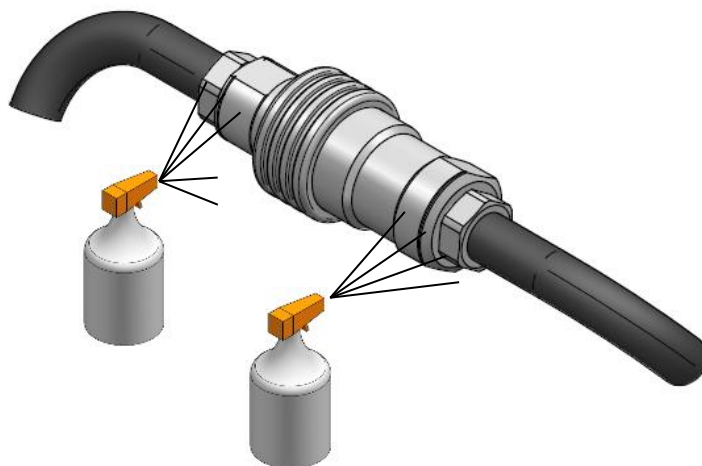

## Connecting Coupler

1. Pull back sleeve.

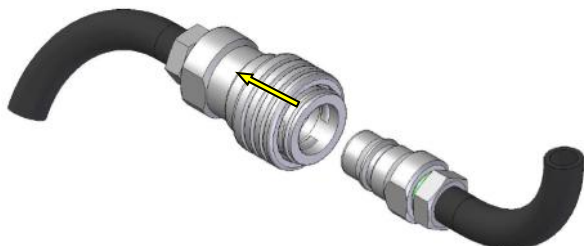

2. Push in male fitting.



3. Sleeve should click forward into place.

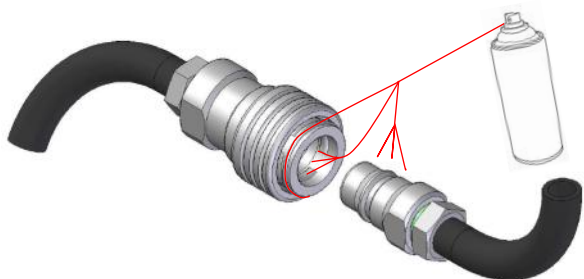

If coupler is hard to uncouple due to cold temperature icing, spray both male & female coupling faces with Interflon Fin Super (aerosol) or a similar product to help with ease of uncoupling in cold conditions.

## Disconnecting Coupler

1. Vent coupler, then pull back sleeve.

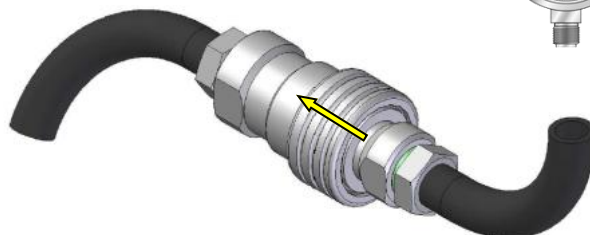

2. Pull out male fitting.

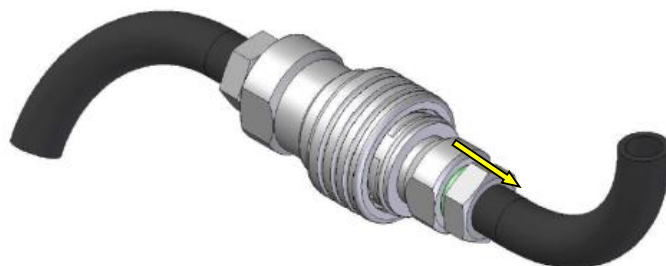

3. The sleeve should return forward.

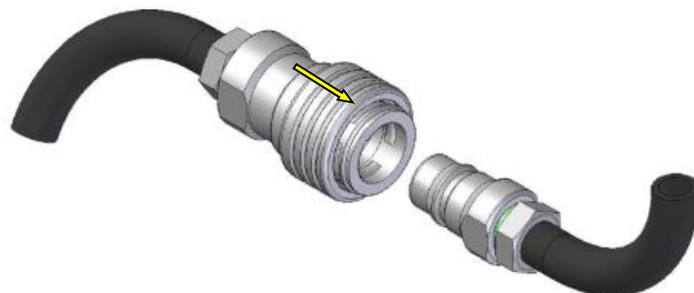

## Service

### Female Part

1 x Poppet



1 x Poppet Spring



1 x O-ring



1 x Backup O-ring



1 x Silicone Grease



### Male Part

1 x Poppet



1 x Poppet Spring



**The Complete Oasis Seal Kit must be used**

## Tools Required

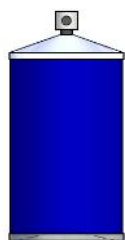

Cleaner (Warm Soapy  
Water or Similar)



Pick Tool  
Part Number:  
TOOL-PICK  
(Sold separately )



Anti Seize Grease  
(Loctite 771 or Similar)  
For All Threads



Spanner  
(Wrenches)



Poppet Assembly Tool  
Part Number:  
TOOL-HC404  
(Sold separately )

1. Clamp female coupler in vice.

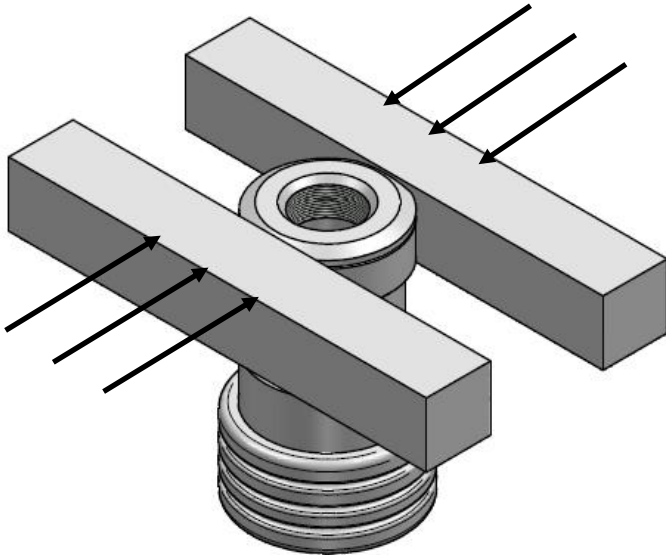

2. Insert the poppet assembly tool.

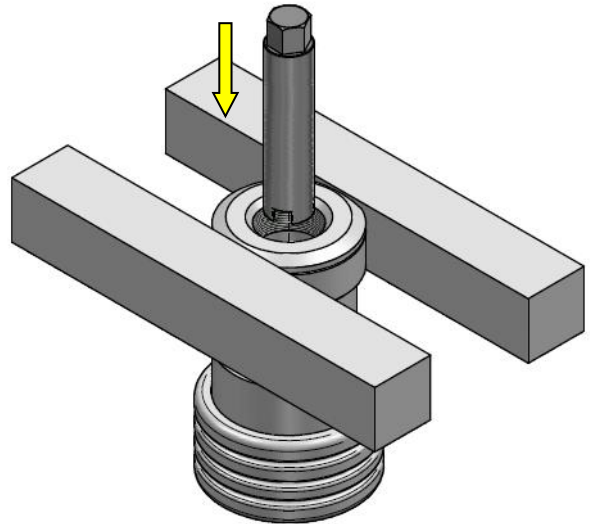

3. Remove the poppet retainer using the assembly tool.

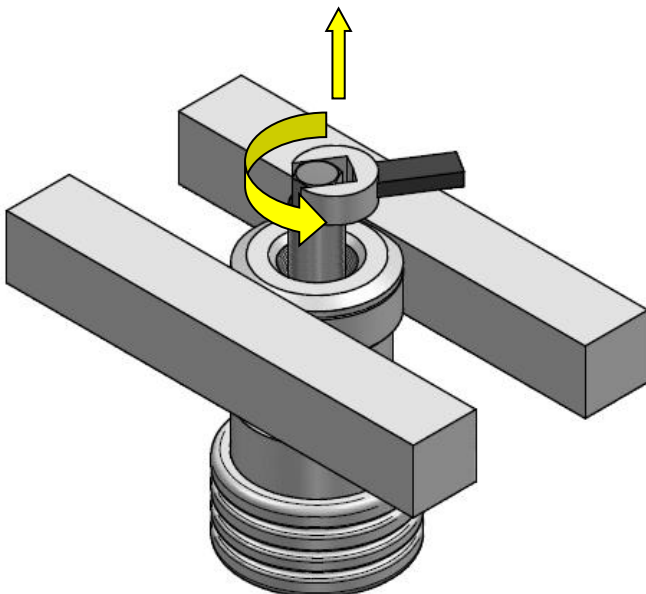

4. Remove and keep the poppet retainer.

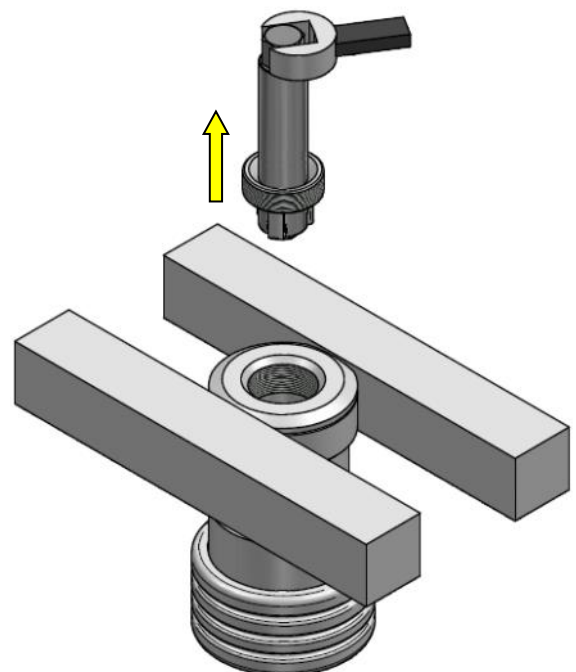



5. Discard the poppet and spring.

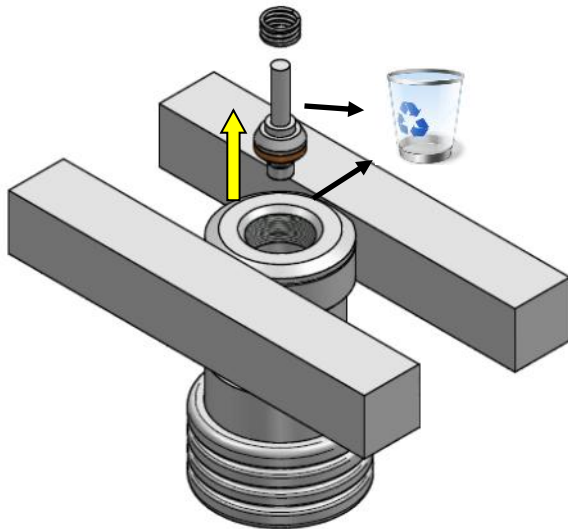

6. Pick out the O-ring and Backup.

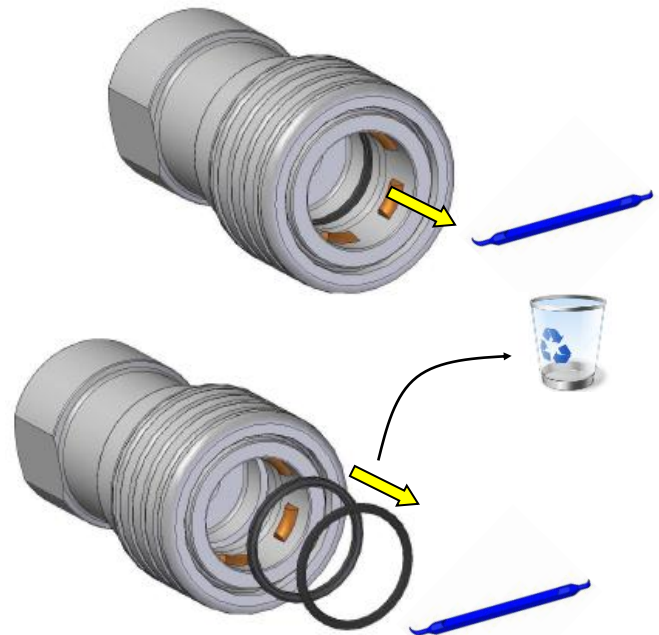

7. Clamp the male coupler in the vice.

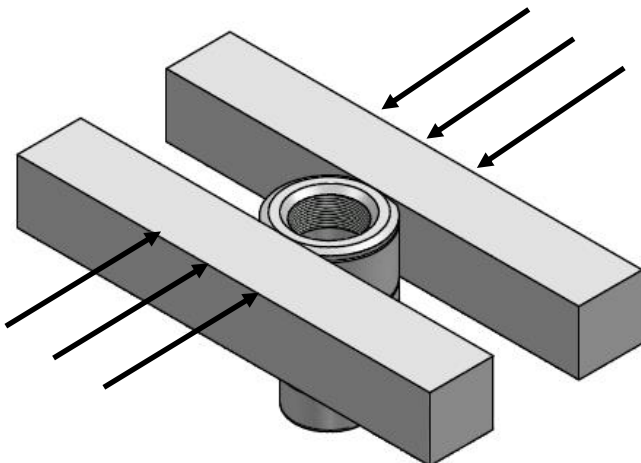

8. Insert the Poppet Assembly Tool.

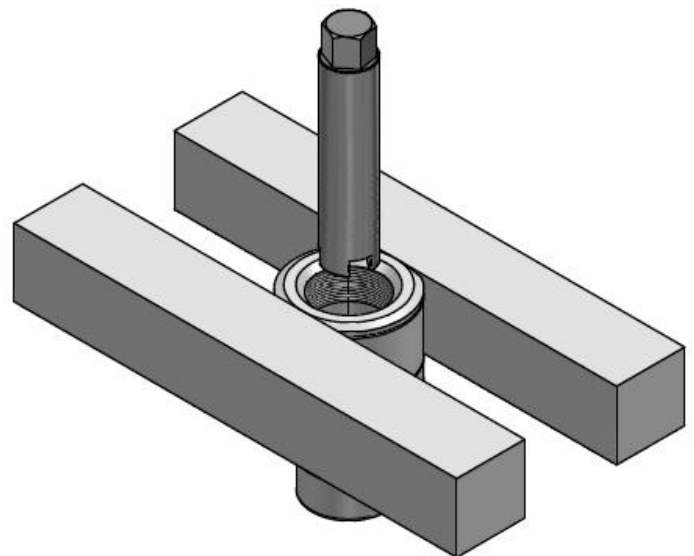



9. Loosen the poppet retainer using the assembly tool.

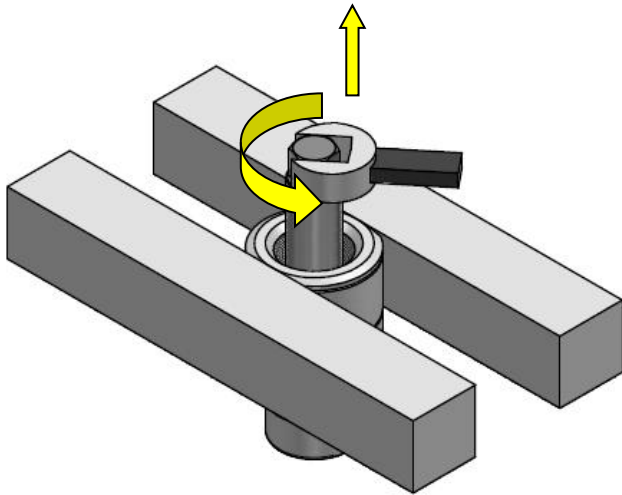

10. Remove and keep the poppet retainer.

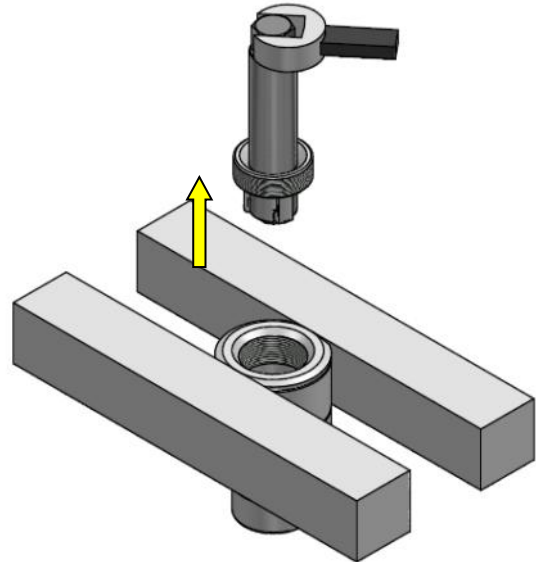

11. Discard the poppet and spring.

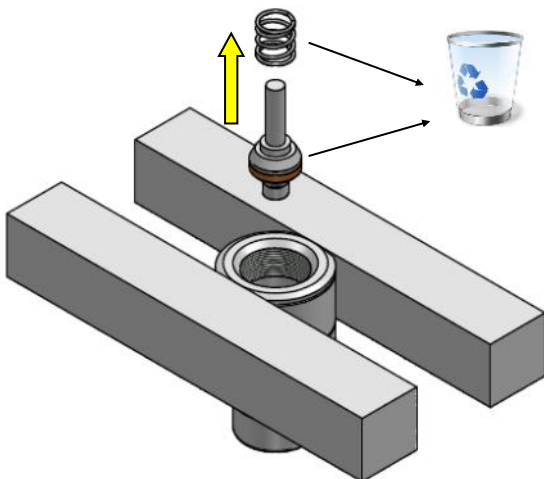

12. Clean all of the components and visually inspect parts for damage.

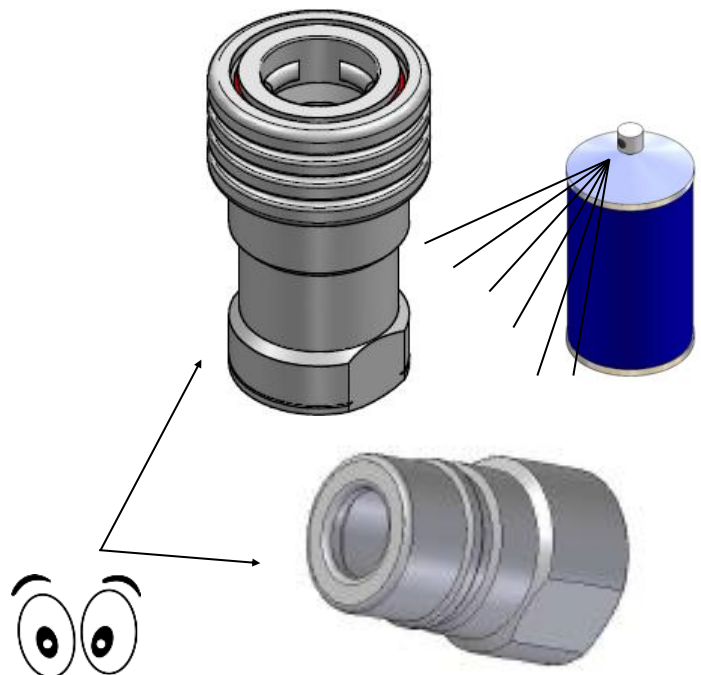

1. Apply anti-seize to the male retainer thread.

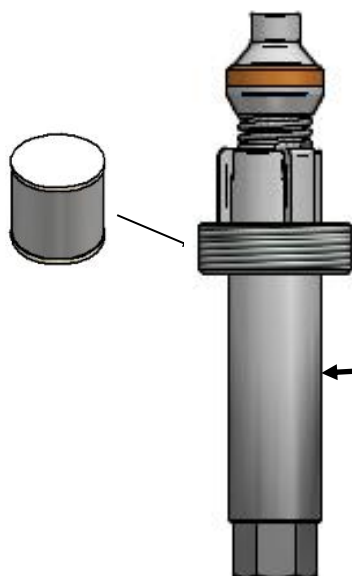

2. Screw in the male body onto the poppet assembly. Be careful not to cross thread the retainer.

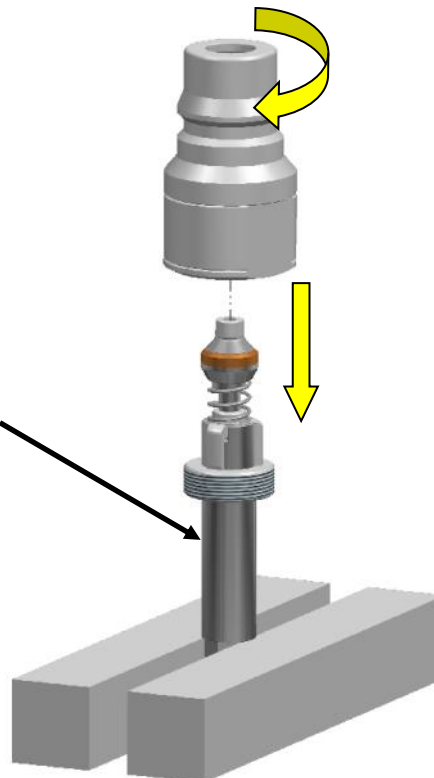

3. Tighten the male poppet retainer. Torque to 18Nm

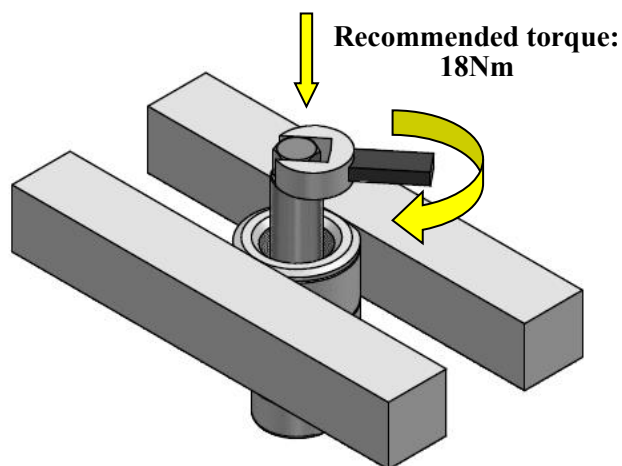

4. Check the poppet by pushing the poppet with your finger and ensure it returns when you release it.

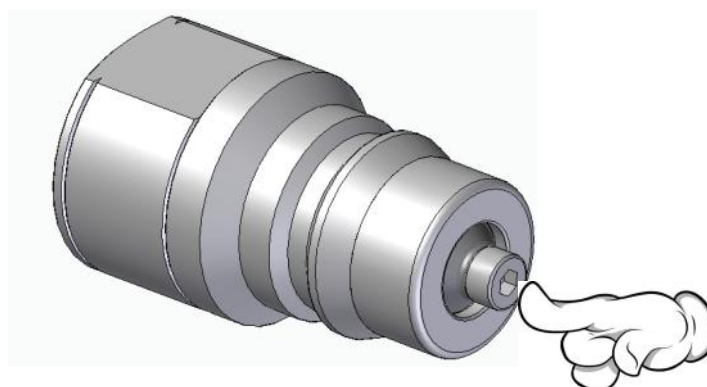

5. Male coupler servicing complete.

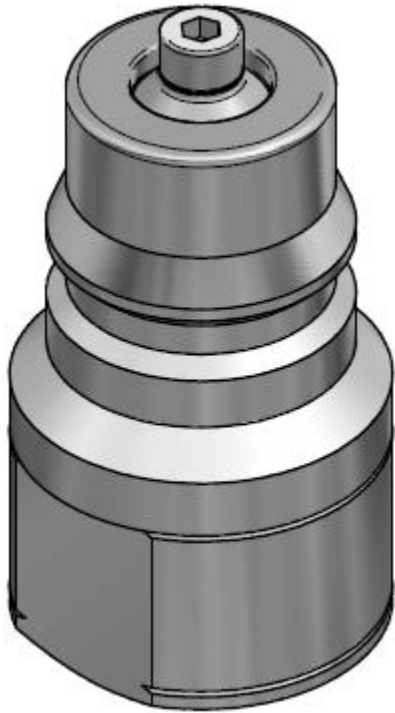

6. Apply anti-seize to the female poppet retainer thread.

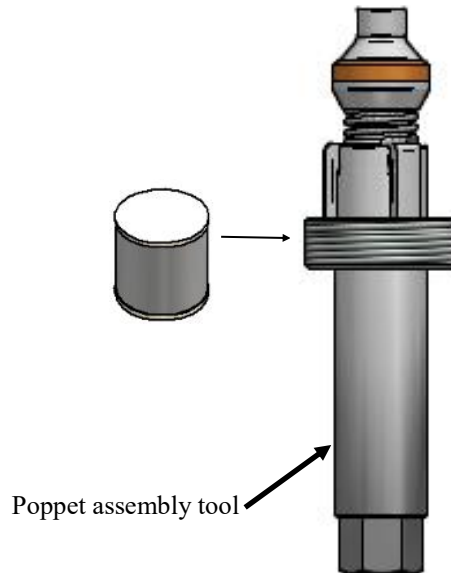

7. Screw the female body onto the poppet assembly. Be careful not to cross thread the retainer.

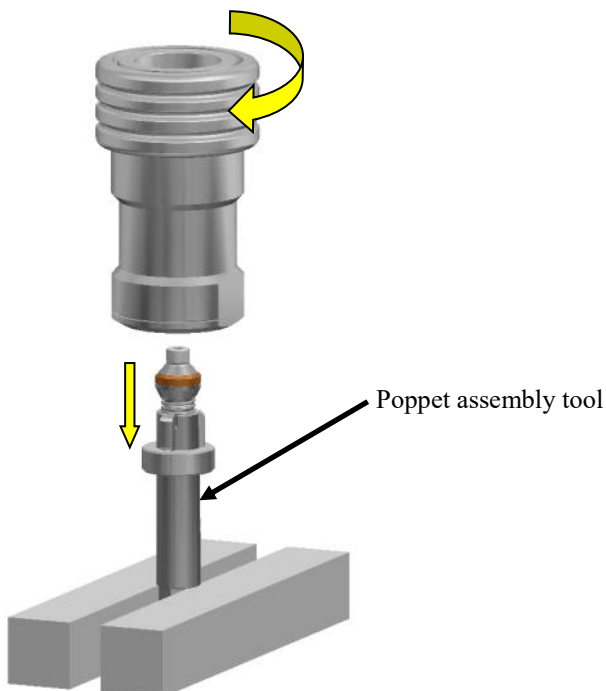

8 Tighten the female poppet retainer.

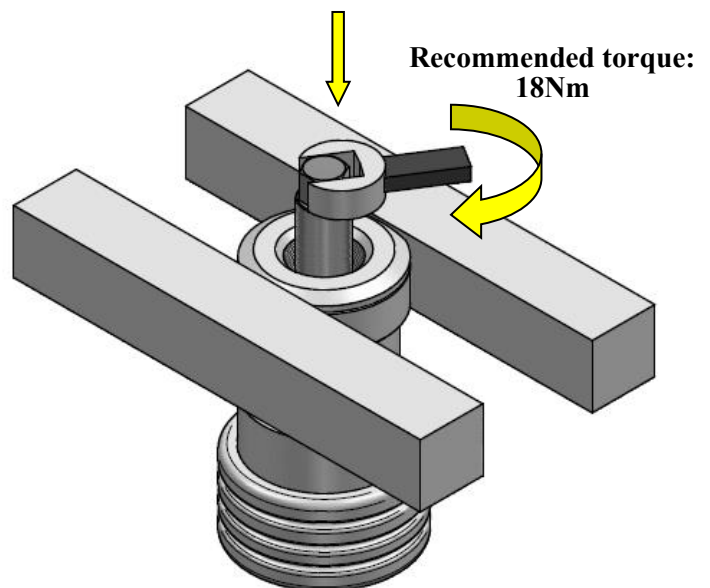

9. Check the poppet by pushing the poppet with your finger and ensure it returns when you release it.

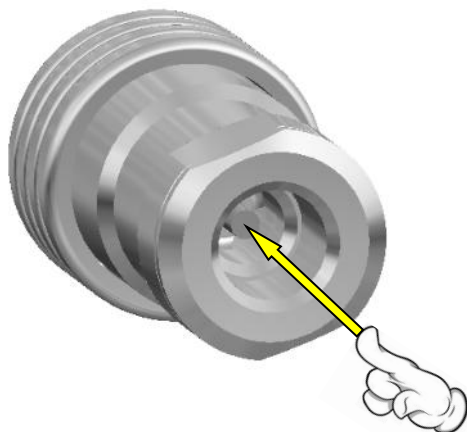

10. Insert the O-ring and back-up.

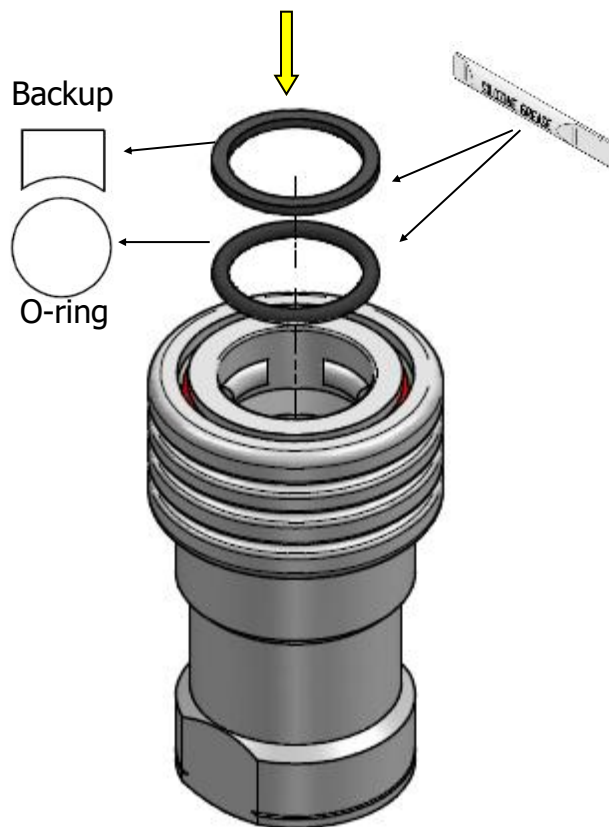

11. Female coupler servicing complete.

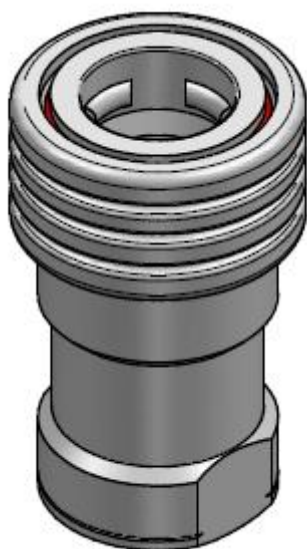

12. Re-install couplers as per the install instructions on page 3 of this manual.

