



# 700 Series Ball Valve with Code 62 Adapter

## Applications

CNG Compressors, Isolation Valves and Storage. Suitable for CNG, Helium, Bio-Gas and Nitrogen, Air and other gases on enquiry.



BV706-4Y6LDDN-M000 - Ball Valve with Code 62 Adapters

## Materials

Item	Part	Material
1	Body	304 Stainless steel
2	Cap	304 Stainless steel
3	Stem	316 Stainless steel
4	Ball	316 Stainless steel
5	Seats	Delrin

Item	Part	Material
6	Seat O-rings	Nitrile
7	Gland & Thrust	Delrin
8	Body O-rings	Nitrile
9	Stem O-rings	Nitrile
10	Handle	304 Stainless Steel

## Product Information

Custom handle options available on request.

NPT/SAE threaded ports available from stock. Other thread types available upon request.

NPT threads conform to ASME B1.20.1.

SAE threads conform to SAE J1926-1.

Code 62 flanges conform to SAE J518-2.

All products are manufactured to ISO 9001 standards.

Complies to PED 2014/68/EU.

CRN (OC14989.59870YTNADD1 & OC12117.2) approved for all provinces.

Video servicing instructions available online at [www.OasisNGV.com/resources](http://www.OasisNGV.com/resources)

## Features & Benefits

The 700 Series Ball Valve is a FULL FLOW, Anti Blowout stem, all stainless steel certified bar stock, two-piece, serviceable valve.

Service kits are readily available & easy to install.

CNC machining allows tighter tolerances to be maintained, which extends the working life of the components.

The complete Oasis range has been cycle tested to ensure **LOWEST LIFE COST**.

Easy servicing with high flow Code 62 flanges .



## 700 Series Ball Valve with Code 62 Adapter

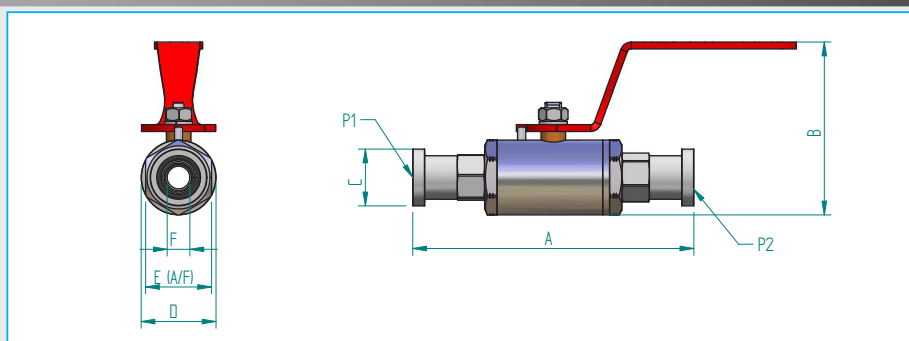

BV706-4Y6LDDN-M000

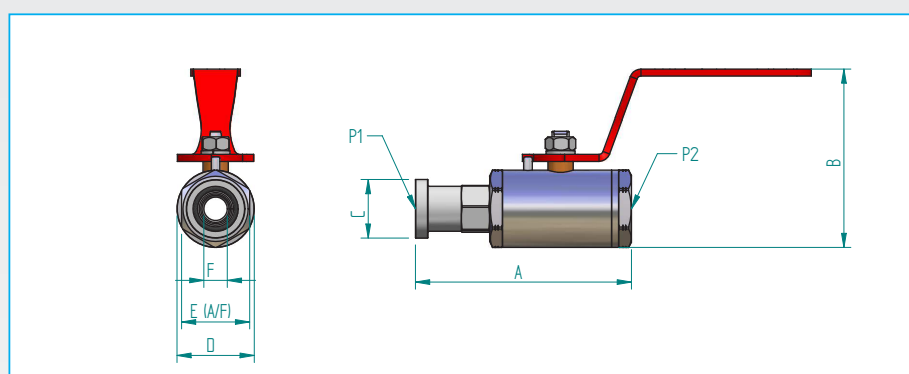

BV706-4X6LDDN-M000 & BV706-4Z6LDDN-M000

### Dimensions Inch (mm)

Part Code	Size	A	B	C	D	E	F (bore)	Port P1	Port P2
BV706-4X6LDDN-M000	3/4"	5.98" (152)	4.96" (126)	1.63" (41.3)	2.16" (55)	1.9" (48)	.65" (16.5)	3/4" Code 62 Flange As per SAE J518-2	1 1/16-12" SAE FEMALE
BV706-4Y6LDDN-M000	3/4"	8.06" (204.7)	4.96" (126)	1.63" (41.3)	2.16" (55)	1.9" (48)	.65" (16.5)	3/4" Code 62 Flange As per SAE J518-2	3/4" CODE 62 ADAPTER AS PER SAE J518-2
BV706-4Z6LDDN-M000	3/4"	5.98" (152)	4.96" (126)	1.63" (41.3)	2.16" (55)	1.9" (48)	.65" (16.5)	3/4" Code 62 Flange As per SAE J518-2	3/4" NPT FEMALE

### Product Specification

Part Code	Mass lb (kg)	Min. Operating Pressure bar (psi) *	Max. Operating Pressure bar (psi) **	Min. Temp. °F (°C)	Max Temp. °F (°C)	Cycles Before Rekit <sup>^</sup>	Stem Open Torque ft-lb (Nm) <sup>^^</sup>	Cv	Service Kit
BV706-4X6LDDN-M000	4.4 (2)	0.5 (7)	410 (6000)	-40 (-40)	185 (85)	100,000	22.8 (31)	21.9	BV706-SK6LDDN-62
BV706-4Y6LDDN-M000	5 (2.3)	0.5 (7)	410 (6000)	-40 (-40)	185 (85)	100,000	22.8 (31)	21.9	BV706-SK6LDDN-62
BV706-4Z6LDDN-M000	4.4 (2)	0.5 (7)	410 (6000)	-40 (-40)	185 (85)	100,000	22.8 (31)	21.9	BV706-SK6LDDN-62

\* Minimum system pressure the product will hold constant bubble tight seal.

\*\* Maximum pressure at which the product can constantly operate at.

<sup>^</sup> It is recommended that the ball valve is re-kitted on or before the maximum number of allowable cycles.

<sup>^^</sup> Opening torque at 6,000 psi

We reserve the right to modify product specifications without prior notice.